

NOTE: Zinc 3Cr. Plated and Black 3Cr. Plated are RoHS compliant trivalent finishes

## HEX SOCKET CAP SCREW ISO 4762 / JIS B1176 / DIN 912

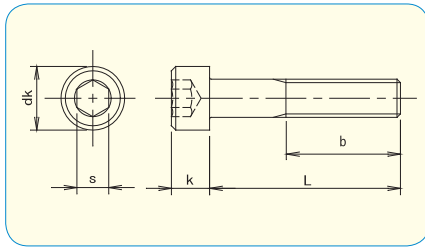

- **Material · plating**  
 Steel 12.9 (~M20) / Black  
 Steel 10.9 (M22~) / Black



How to order or inquire: R830-912-12- diameter x length (up to M20)  
 How to order or inquire: R830-912-10- diameter x length (M22 and up)  
 Examples: R830-912-12 3x10, R830-912-10 24x35

	M1.6	M2	M2.5	M2.6	M3	M4	M5	M6	M8	M10	M12
dk	3	3.8	4.5	4.5	5.5	7	8.5	10	13	16	18
k	1.6	2	2.5	2.6	3	4	5	6	8	10	12
s	1.5	1.5	2	2	2.5	3	4	5	6	8	10
b	15	16	17	17	18	20	22	24	28	32	36

pcs / Box

d L	M1.6	M2	M2.5	M2.6	M3	M4	M5	M6	M8	M10	M12
3	1,000	500	500	500	500						
4	1,000	500	500	500	500	500	500				
5	1,000	500	500	500	500	500	500	200			
6	1,000	500	500	500	500	500	500	200			
8	1,000	500	500	500	500	500	500	200	100		
10	1,000	500	500	500	500	500	500	200	100	100	
12		500	500	500	500	500	500	200	100	100	100
14		500	500	500	500	500	500	200	100	100	
15		500	500	500	500	500	500	200	100	100	100
16		500	500	500	500	500	500	200	100	100	100
18		500	500	500	500	500	500	200	100	100	100
20		500	500	500	500	500	500	200	100	100	100
22					500	200	200	200	100	100	100
25					200	200	200	200	100	100	100
28					200	200	200	200	100	100	100
30					200	200	200	100	100	100	100
35					200	200	200	100	100	100	50
40					200	200	200	100	100	100	50
45					200	200	200	100	100	100	50
50					200	200	200	100	100	50	50
55						200	200	100	100	50	50
60						200	200	100	100	50	50
65						200	200	100	100	50	50
70						200	200	100	100	50	50
75								100	100	50	50
80								100	100	50	50
85								100	100	50	50
90								100	100	50	25
95								100	50	50	25
100								100	50	50	25
105									50	50	25
110					300				50	50	25
115									50	50	25
120									50	50	25
125									50	25	25
130									50	25	25
140									50	25	25
150									50	30	25
155											
160										30	25
165											
170										30	25
180										30	25
190										30	25
200										30	25

# HEX SOCKET CAP SCREW ISO 4762 / JIS B1176 / DIN 912

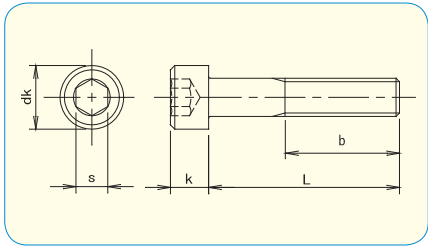

- **Material · plating**  
 Steel 12.9 (~M20) / Black  
 Steel 10.9 (M22~) / Black



How to order or inquire: R830-912-12- diameter x length (up to M20)  
 How to order or inquire: R830-912-10- diameter x length (M22 and up)  
 Examples: R830-912-12 3x10, R830-912-10 24x35

	M1.6	M2	M2.5	M2.6	M3	M4	M5	M6	M8	M10	M12
dk	3	3.8	4.5	4.5	5.5	7	8.5	10	13	16	18
k	1.6	2	2.5	2.6	3	4	5	6	8	10	12
s	1.5	1.5	2	2	2.5	3	4	5	6	8	10
b	15	16	17	17	18	20	22	24	28	32	36

	M14	M16	M20	M24	M36
dk	21	24	30	36	54
k	14	16	20	24	36
s	12	14	17	19	27
b	40	44	52	60	84

pcs / Box

L \ d	M14	M16	M20	M24	M36
20	50				
25	50	50			
30	50	50		20	
35	50	40		20	
40	50	40	40		
45	50	40	40		
50	50	30	35		
55	40	30	30		
60	40	30	30		1
65	40	25	30		
70	40	25	25		1
75	40	25	25		
80	40	25	25		1
85	30	25	25		
90	30	20	25		1
95	30	20	25		
100	30	20	20		1
105		20			
110		20			1
115		15			
120		15			1
125		15			
130		15			1
140		15			1
150		15			1
160					1
170					1
180					1
190					1
200					1
210					1
220					1
230					1
240					1
250					1
260					1
280					1
300					1

NOTE: Zinc 3Cr. Plated and Black 3Cr. Plated are RoHS compliant trivalent finishes

# HEX SOCKET CAP SCREW ISO 4762 / JIS B1176 / DIN 912

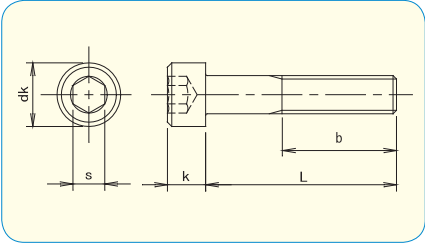

- **Material · plating**  
 Steel 10.9 / Zinc 3Cr. Plated  
 Steel 10.9 / Zinc Black 3Cr. Plated



How to order or inquire: R830-912-10-finish code diameter x length

Example: R830-912-10-CR3 4x10

Finish codes: CR3 for Zinc 3Cr. Plated, CR3B for Black 3Cr. Plated

	M2	M2.5	M2.6	M3	M4	M5	M6	M8	M10	M12
dk	3.8	4.5	4.5	5.5	7	8.5	10	13	16	18
k	2	2.5	2.6	3	4	5	6	8	10	12
s	1.5	2	2	2.5	3	4	5	6	8	10
b	16	17	17	18	20	22	24	28	32	36



d L											pcs / Box
		M2	M2.5	M2.6	M3	M4	M5	M6	M8	M10	M12
3		500	500	500	500						
4		500	500	500	500	500					
5		500	500	500	500	500	500				
6		500	500	500	500	500	500	500			
8		500	500	500	500	500	500	500			
10		500	500	500	500	500	500	500	100	100	
12		500	500	500	500	500	500	500	100	100	
14		500	500	500	500	500	500	500	100	100	
15		500	500	500	500	500	200	200	100	100	
16		500	500	500	500	500	200	200	100	100	
18		500	500	500	500	500	200	200	100	100	
20		500	500	500	500	200	200	200	100	100	
25			500		500	200	200	200	100	100	50
30					500	200	200	200	100	50	50
35					500	200	200	100	100	50	50
40					500	200	200	100	100	50	50
45					500	200	200	100	100	50	50
50					200	200	200	100	100	50	
55					200	200	200	100	50	50	
60					200	200	200	100	50	50	40
65							200	100			
70						200	200	100		50	
75						200		100			
80							100	100			
85						100					
90								100			
100								100	50	30	
110											
120									50		

# HEX SOCKET CAP SCREW ISO 4762 / JIS B1176 / DIN 912

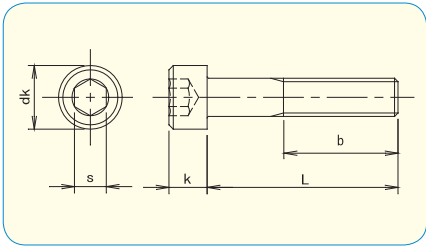

● **Material**  
Stainless Steel A2



How to order or inquire: R830-DIN 912A2 diameter x length

Example: R830-DIN 912A2 4x16

Material codes: A2 for Stainless Steel A2

	M1.6	M2	M2.5	M2.6	M3	M4	M5	M6	M8	M10
dk	3	3.8	4.5	4.5	5.5	7	8.5	10	13	16
k	1.6	2	2.5	2.6	3	4	5	6	8	10
s	1.5	1.5	2	2	2.5	3	4	5	6	8
b	15	16	17	17	18	20	22	24	28	32



		pcs / Box									
L \ d		M1.6	M2	M2.5	M2.6	M3	M4	M5	M6	M8	M10
3		1,000	1,000	1,000	1,000	1,000					
4		1,000	1,000	1,000	1,000	500	1,000				
5		1,000	1,000	1,000	1,000	500	500	500			
6		1,000	1,000	1,000	1,000	500	500	500	500		
8		1,000	1,000	1,000	1,000	500	500	500	200	100	
10		1,000	1,000	1,000	1,000	500	500	500	200	100	100
12		1,000	1,000	1,000	1,000	500	500	500	200	100	100
14			1,000	1,000	1,000	500	500	500	200	100	100
15			1,000	1,000	1,000	500	500	500	200	100	100
16			1,000	1,000	1,000	500	500	200	200	100	100
18			1,000	1,000	1,000	500	500	200	200	100	100
20			1,000	1,000	1,000	500	500	200	200	100	100
22						200	500	200	200	100	100
25			1,000	1,000	1,000	200	500	200	200	100	100
28						200	200	200	200	100	100
30			1,000	1,000	1,000	200	200	200	200	100	50
35						200	200	200	200	100	50
40			1,000	1,000	1,000	200	200	200	200	100	50
45						200	200	100	200	100	50
50						200	200	100	200	100	50
55						200	200	100	100	50	50
60						200	200	100	100	50	50
65						200	200	100	100	50	50
70						200	200	100	100	50	40
75						200	200	100	100	50	40
80						200	200	100	100	50	40
85						200	200	100	100	50	40
90						200	200	100	100	50	30
95						200	100	100	100	50	30
100						200	100	100	100	50	30
105								100	100	50	25
110							100	100	100	50	30
115							100	100	100	50	25
120							100	100	100	50	30
125								100	100	50	25
130							100	100	100	50	30
140							100	100	100	50	30
150							100	100	100	50	30
155								100		50	30
160								100	100	50	30
165											30
170								100	100	50	30
180								100	100	70	30
190								100	100	70	30
200								100	100	70	30
210										70	
220										50	30
230										50	30
240											
250										50	30

# HEX SOCKET CAP SCREW ISO 4762 / JIS B1176 / DIN 912

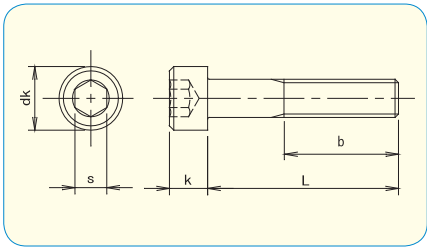

● **Material**  
Stainless Steel A2



How to order or inquire: R830-DIN 912A2 diameter x length

Example: R830-DIN 912A2 4x16

Material codes: A2 for Stainless Steel A2

	M12	M14	M16	M18	M20	M22	M24	M27	M30	M33	M36
dk	18	21	24	27	30	33	36	40	45	50	54
k	12	14	16	18	20	22	24	27	30	33	36
s	10	12	14	14	17	17	19	19	22	24	27
b	36	40	44	48	52	56	60	66	72	78	84

L	pcs / Box										
	M12	M14	M16	M18	M20	M22	M24	M27	M30	M33	M36
12	50										
14	50										
15	50										
16	50										
18	50										
20	50	40	40								
22	50										
25	50	40	50		20						
30	50	40	50	10	20	15	5				
35	50	40	50	10	20	15	5				
40	50	30	40	10	20	15	5				
45	50	30	40	10	15	15	5				
50	40	30	40	10	15	15	5	5	4		
55	40	25	35	10	15	15	5	5	4		
60	30	25	30	10	15	15	5	5	4		
65	30	25	30	10	15	15	5	5	4		
70	30	25	30	10	15	15	5	5	4	1	1
75	30	25	25	10	12	15	5	5	4	1	1
80	30	25	25	10	12	15	5	5	4	1	1
85	30	25	25	10	10	15	5	5	4	1	1
90	25	25	25	10	10	15	5	5	4	1	1
95	25	15	20		10	15	5	5	4		1
100	25	15	20	10	10	15	5	5	4	1	1
105	25	15	15			15	5				
110	20	15	15	10	10	15	5	5	4	1	1
115	20	15	15			15	5				
120	20	15	12	10	8	15	5	5	4	1	1
125	20	15	15			10	5				
130	20	15	12	10	8	10	5	5	4	1	1
140	20	15	12	10	8	10	5	5	4	1	1
150	20	15	12	10	6	10	5	5	4	1	1
160	20	15	12	10	6	10	5	5	4		1
170	20	15	12	10	6	10	5	5	4		1
180	20	15	12	10	6	10	5	5	4		1
190	20	15	12		6	10	5	5	3		1
200	20	15	10	10	6	10	5	5	3		1
210			10								
220	20		10								
230	20		10		6		5		3		
240	20		10								
250	20	20	10		6	10	5	5	3		1
260			10								
280							5				
300	20	15	10		5	10	5	5	3		1