

# /T 96.1-2002 Plain washers-Large series-Product grad

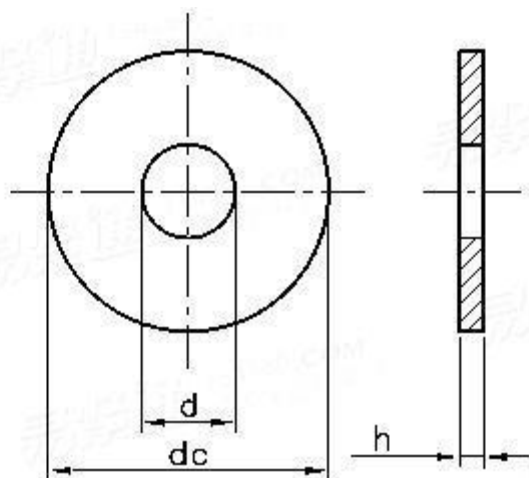

Unit: mm

Nom	d		dc		h			Weight of per 1000 steel products ≈kg
	min	max	max	min	Nom	max	min	
3	3.2	3.38	9	8.64	0.8	0.9	0.7	0.349
3.5	3.7	3.88	11	10.57	0.8	0.9	0.7	0.529
4	4.3	4.48	12	11.57	1	1.1	0.9	0.774
5	5.3	5.48	15	14.57	1	1.1	0.9	1.21
6	6.4	6.62	18	17.57	1.6	1.8	1.4	2.79
8	8.4	8.62	24	23.48	2	2.2	1.8	6.23
10	10.5	10.77	30	29.48	2.5	2.7	2.3	12.17
12	13	13.27	37	36.38	3	3.3	2.7	22.19
14	15	15.27	44	43.38	3	3.3	2.7	31.64
16	17	17.27	50	49.38	3	3.3	2.7	40.89
18	19	19.33	56	55.26	4	4.3	3.7	68.43
20	21	21.33	60	59.26	4	4.3	3.7	77.9
22	23	23.52	66	64.8	5	5.6	4.4	118
24	25	25.52	72	70.8	5	5.6	4.4	140.5
27	30	30.52	85	83.6	6	6.6	5.4	234
30	33	33.62	92	90.6	6	6.6	5.4	272.8
33	36	36.62	105	103.6	6	6.6	5.4	359.9
36	39	39.62	110	108.6	8	9	7	521.8